



U.S. History to 1877

# STUDENT FIELD TRIP GUIDE

Embrace Ideals, Challenge Reality,  
Participate in Repair

**DALLAS** \_\_\_\_\_  
**HOLOCAUST** AND  
**HUMAN RIGHTS**  
\_\_\_\_\_  
**MUSEUM**



STUDENT NAME:

SCHOOL NAME:

CHAPERONE NAME:

GROUP NUMBER:



**1 MATCH:** To identify an **Upstander**, we must first define who is an **Upstander**. View the film in the Orientation Theater and then match the definitions with the correct term:

<b>1</b> UPSTANDER	<input type="checkbox"/> Someone who stands up for what is right to protect others and sometimes themselves.
<b>2</b> BYSTANDER	<input type="checkbox"/> Someone who is fueled by hatred, prejudice, and racism.
<b>3</b> VICTIM	<input type="checkbox"/> Someone who does nothing.
<b>4</b> PERPETRATOR	<input type="checkbox"/> Someone who endures the worst of humanity: discrimination, expulsion, oppression, slavery, and murder.



**2 FILL IN THE BLANK:** As you walk up the orientation staircase , listen to the videos about the history of Judaism and complete the sentence below.

“Moses climbed the holy mountain and received God’s commandments on two stone tablets. The guiding principle of the 10 commandments being – Human life is \_\_\_\_\_.”

(fill in the blank)

Connect to U.S. History: Which of our rights as United States citizens does this sound most similar to?  
(Circle the correct answer)

Right to bear arms

Right to life

Freedom of the press

Right to liberty



U.S. History to 1877

# STUDENT FIELD TRIP GUIDE

Embrace Ideals, Challenge Reality,  
Participate in Repair

DALLAS  
**HOLOCAUST** AND  
**HUMAN RIGHTS**  
MUSEUM

3

**SORT:** Germany's government went from a limited government to an unlimited government with Hitler's rise to power. Sort the events showing actions of a limited or unlimited government into the T-chart.

- A** Hitler appointed Chancellor
- B** Nuremberg Laws
- C** Burning of the Reichstag building
- D** Kristallnacht



Limited	Unlimited

4

**CONNECTING HISTORY:** Look for this image in the Nazi Germany Gallery and answer the questions below.

What is *lebensraum*? (define)

What part of U.S. history inspired Hitler? (circle one)

Women's  
Suffrage

Slavery

Westward  
Expansion



5

**SELECT:** After listening to a survivor testimony station, circle a word below that best describes how you feel.

**SAD** **CONFUSED** **OVERWHELMED** **INSPIRED**  
**MOTIVATED** **ANGRY** **HEARTBROKEN**  
**CHANGED** **WORRIED**



U.S. History to 1877

# STUDENT FIELD TRIP GUIDE

Embrace Ideals, Challenge Reality,  
Participate in Repair

**DALLAS**  
**HOLOCAUST AND**  
**HUMAN RIGHTS**  
**MUSEUM**



**CONNECT THE IDEALS:** In the Human Rights Gallery, find the Universal Declaration of Human Rights (UDHR). Eleanor Roosevelt strongly influenced the UDHR. Draw a connecting line to match ideals listed in American founding documents to similar ideals listed in the Universal Declaration of Human Rights.

## Rights of Citizens of the United States



Freedom of Religion, Assembly,  
Press, Petition, Speech

[All persons] are endowed by their  
creator with certain unalienable  
rights, among these are life,  
liberty, & the pursuit of happiness

No excessive bail and no cruel or  
unusual punishment

No person shall be deprived of life,  
liberty, or property without due  
process of law (a trial)

Neither slavery nor involuntary  
servitude shall exist in the United  
States

We hold these truths to be self-  
evident that all men are created  
equal

## Universal Declaration of Human Rights



Everyone has the right to life,  
liberty, and security of person

No one shall be held in slavery or  
servitude

No one shall be subjected to  
torture, or to cruel, inhumane, or  
degrading treatment or  
punishment

Everyone is entitled to a fair and  
public hearing by an impartial  
tribunal (court) in the  
determination of any criminal  
charges against him

Everyone has the right to freedom  
of thought, conscience, and  
religion

All human beings are born free and  
equal in dignity and rights

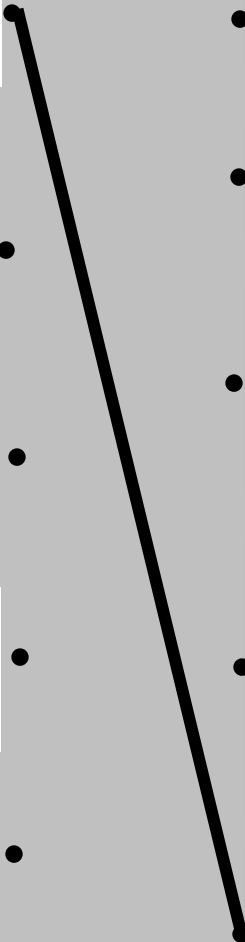



U.S. History to 1877

# STUDENT FIELD TRIP GUIDE

Embrace Ideals, Challenge Reality,  
Participate in Repair

DALLAS  
**HOLOCAUST** AND  
**HUMAN RIGHTS**  
MUSEUM



**FIND AND EVALUATE:** Find the images/objects below in the 10 Stages of Genocide Gallery and match them with the correct stage in the process of genocide. Then, study the stage of persecution and answer the question.



CLASSIFICATION



ORGANIZATION



DISCRIMINATION



DENIAL



Evaluate the artistic  
installation depicting  
Persecution. What connection  
does this sculpture have to  
Texas?



**WHAT'S MISSING?:** Listen to the Pivot to America orientation film and fill in the missing information

The ideals established certify \_\_\_\_\_ which are \_\_\_\_\_,  
\_\_\_\_\_, & \_\_\_\_\_.

This is how our system was set up. It's a constant \_\_\_\_\_ & \_\_\_\_\_  
about how our ideals are reflected in our daily lives.

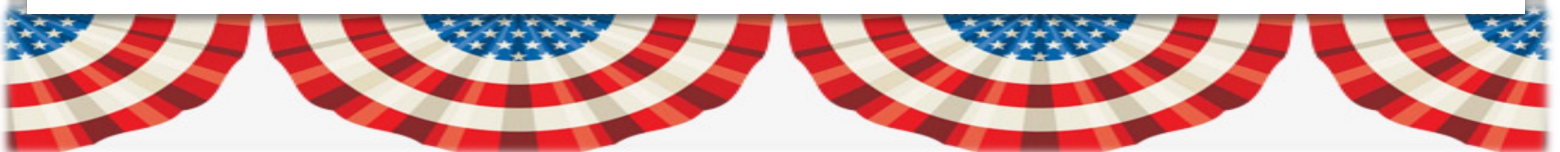





U.S. History to 1877

# STUDENT FIELD TRIP GUIDE

Embrace Ideals, Challenge Reality,  
Participate in Repair

**DALLAS**  
**HOLOCAUST AND**  
**HUMAN RIGHTS**  
**MUSEUM**



**MATCHING:** Use the interactive stations in the middle of the Pivot to America Gallery to match the following **Upstanders** with their accomplishments. (Hint: Use the search function to find **Upstanders**.)

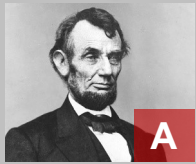

Abraham Lincoln



Dorothea Dix



Thomas Jefferson

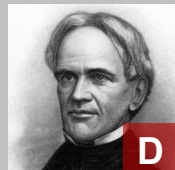

Horace Mann



Abigail Adams



Harriet Tubman



Elizabeth Stanton

	Women's rights advocate who wrote "Remember the Ladies."
	Wrote the Emancipation Proclamation and worked to pass the 13th amendment.
	Conductor on the Underground Railroad who returned to the south 19 times to bring other slaves to freedom.
	Founded the Common School Movement.
	Organized the Seneca Falls Convention, the world's first women's rights convention.
	Wrote the Virginia Statute for Religious Freedom & the Declaration of Independence.
	Advocated for the better treatment of the mentally ill.



**CAUSE AND EFFECT:** Use the interactive stations to complete the graphic organizer with the correct cause or effect.

**REALITY (cause)**

**REPAIR (effect)**

EXAMPLE:

Roger Williams was banished from the Massachusetts Bay Colony for his beliefs in religious freedom.

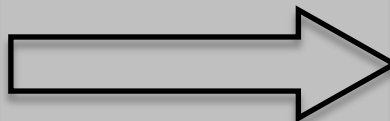

Roger Williams founded the colony of Rhode Island for religious tolerance.

YOUR  
TURN:

Black Codes in the south prevented African American males from voting.

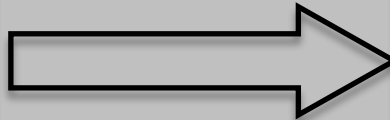



U.S. History to 1877

# STUDENT FIELD TRIP GUIDE

Embrace Ideals, Challenge Reality,  
Participate in Repair

DALLAS  
**HOLOCAUST** AND  
**HUMAN RIGHTS**  
MUSEUM

11

**COMPARE & CONTRAST:** Find these two Upstanders in the interactive stations, and correctly fill in the Venn Diagram with their similarities and differences. (Hint: Use the search function to find **Upstanders**.)

Frederick  
Douglass

Martin Luther  
King, Jr.

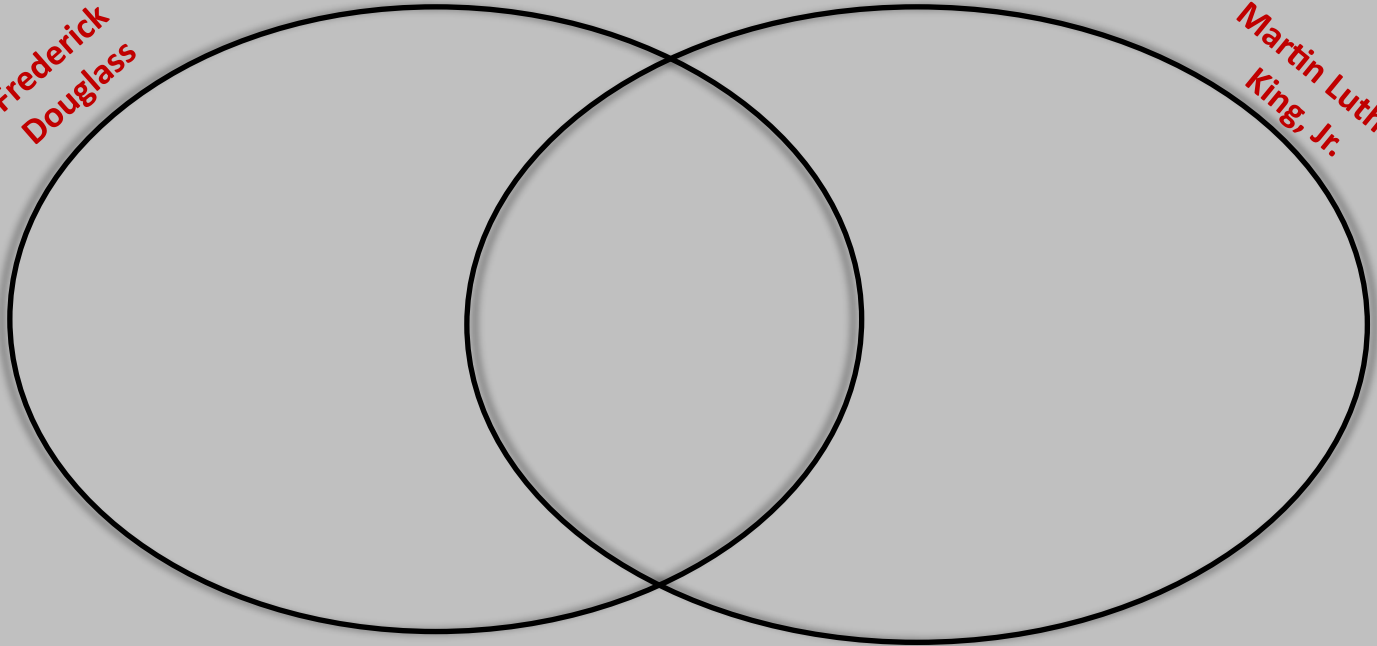

12

**CALL TO ACTION:** We looked at a lot of **Upstanders**. Now it is your turn to act. Go to the Call to Action Gallery and as a group complete the interactive experience. What organization and activity did you select?

What organization did you select?

---

Why did you select this organization?

---

---

How will this organization benefit your community?

---

---



U.S. History to 1877

# STUDENT FIELD TRIP GUIDE

Embrace Ideals, Challenge Reality,  
Participate in Repair

**DALLAS**  
**HOLOCAUST AND**  
**HUMAN RIGHTS**  
**MUSEUM**

## 1st Floor

Exhibit Entrance

Special Exhibit

Classrooms

Cinemark Theater  
(1st floor entrance)

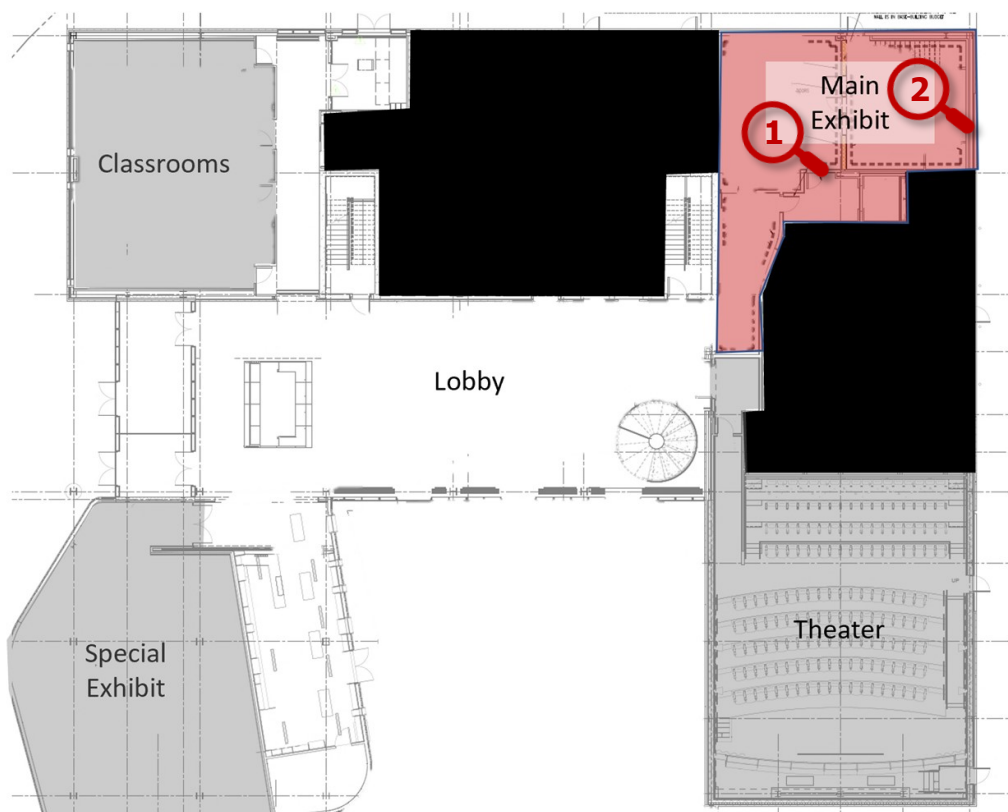

## 2nd Floor

Dimensions in Testimony  
Theater

Lunch Patio

Cinemark Theater  
(2nd floor entrance)

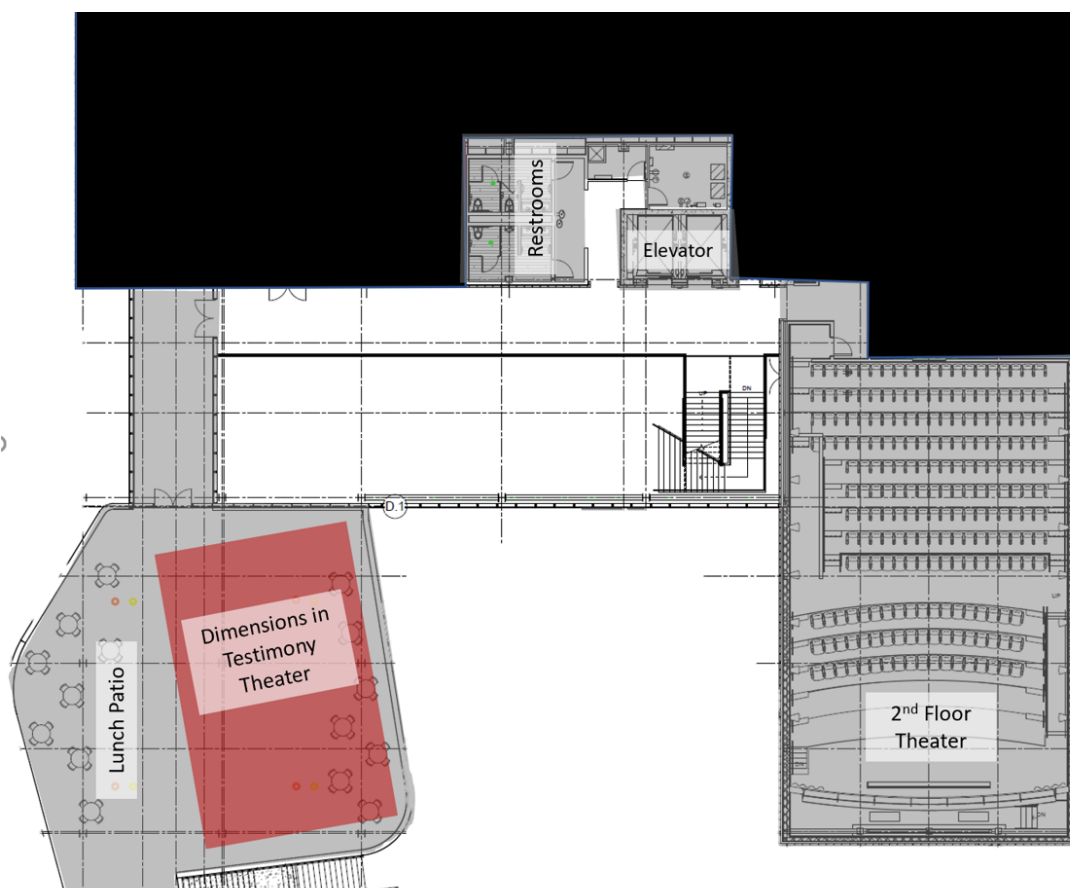



U.S. History to 1877

# STUDENT FIELD TRIP GUIDE

Embrace Ideals, Challenge Reality,  
Participate in Repair

DALLAS  
**HOLOCAUST** AND  
**HUMAN RIGHTS**  
MUSEUM

## 3rd Floor

### Exhibit

